

WE NEED YOUR SUPPORT TO URGENTLY FIX THE COCKWHY BRIDGE!

The Problem

The bridge over the Cockwhy Creek, along Dangerboard Road, has deteriorated badly over many years and was further damaged during the 2019/20 fires. The photos below show the current state of the bridge and road. It is no longer safe to handle heavy vehicles greater than 2 tonnes, much less a 13 tonne fully laden RFS fire truck. Dangerboard road is also in an extremely poor state of repair and in places is impassable. The problems have been raised many times with political representatives and various State Government and Council authorities over the last 5 years, but no one is prepared to take responsibility for the problem and have the road and bridge fixed.

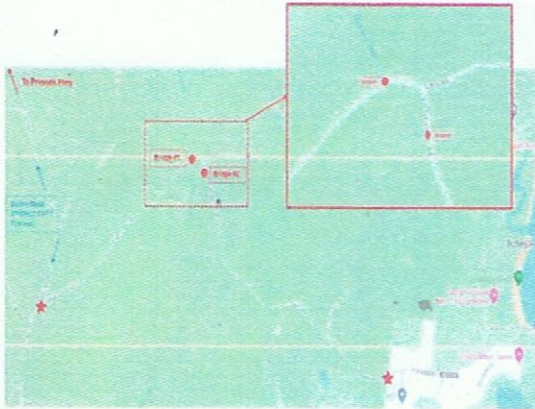

Why do we need the Cockwhy Creek Bridge and Dangerboard Road?

Bawley Point and Kioloa can only be accessed off the Princess Highway via Bawley Point and Murrmarang Roads. If there is a fire or other emergency cutting off those roads, there are no other safe escape route for our residents and visitors.

Dangerboard Road and the Cockwhy Creek bridge at the southern end of Kioloa, have historically provided an alternative escape route/access to the highway. This is no longer possible and is a significant risk to all members of our community. Additionally, RFS trucks cannot reach a fire on the southern side of the bridge and intercept it before it reaches the village of Kioloa. Also, If Bawley Point or Murrmarang Roads are closed due to fire, fallen power lines, or trees, this could prevent other brigades and emergency services from reaching our villages and helping our residents.

What can you do to help?

Please contact your Council, State Government representatives and local radio stations and raise these very real concerns as residents and visitors to our beautiful villages. Urge them to take action now before the worst part of the fire season is upon us. Some contacts are:

The Hon Jihad Dib, MP, Minister for Emergency Services using website contact form.

Fiona Phillips, MP Member for Gilmour. E. Fiona.phillips.mp@aph.gov.au

Liza Buttler, MP Member for South Coast. E southcoast@parliament.nsw.gov.au

Patricia White, Shoalhaven Council. E. patricia.white@shoalhaven.nsw.gov.au

Ms Robyn Stevens, CEO, Shoalhaven City Council E. council@shoalhaven.nsw.gov.au

Mr Graeme Day, 2ST Radio station P. 4423 2999 or use the contact form on the 2ST website