

EASTERN EDGE OF PATH LONGITUDINAL SECTION - VIEW 3  
 SCALES H 1:500 @ A1, 1:1,000 @ A3  
 V 1:50 @ A1, 1:100 @ A3

ISSUE	DESCRIPTION	DATE
B	RE-ISSUED FOR CONSTRUCTION	18/10/21
A	ISSUED FOR CONSTRUCTION	24/09/21

ISSUED FOR CONSTRUCTION

FOOTPRINT (NSW) PTY. LTD. AUTHORISE THE USE OF THIS DRAWING ONLY FOR THE PURPOSE DEMONSTRATED BY THE STATUS STAMP SHOWN ABOVE.

SCALES	ORIGINAL
AS NOTED	A1

CLIENT: Shoalhaven City Council

SURVEYOR:	SCC
DATUM:	AHD
AZIMUTH:	MGA
DRAWN:	AB
DESIGNED:	AB
DESIGNED DATE:	AUG 2021
CHECKED:	AB

footprint sustainable engineering  
 a. 15 meehan drive  
 kiama downs nsw 2533  
 p. 02 4237 6770  
 m. 0430 421 661

MURRAMARANG ROAD, BAWLEY POINT  
 PROPOSED SHARED USER PATH  
 BAWLEY POINT TO KIOLOA  
 PLAN AND LONGITUDNAL SECTION - VIEW 3

Shoalhaven City Council  
 PLAN REFERENCE  
**5515.05**

DRAWING NO.  
**2062-C05**

ISSUE.  
**B**

SHEET 5 OF 26

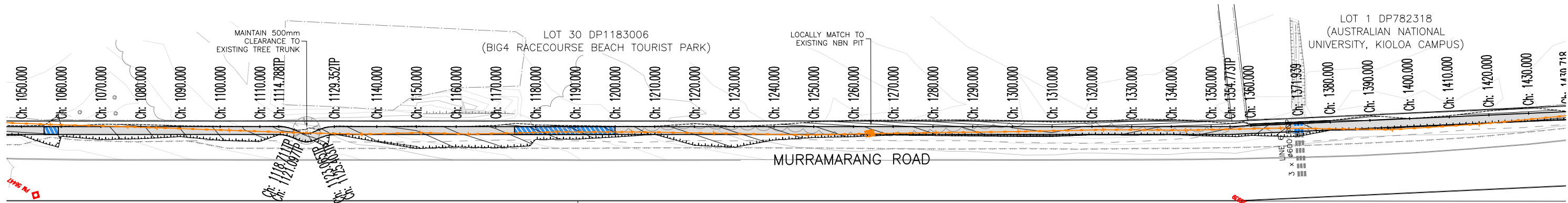

**VIEW 4**

SCALE 1:500 @ A1  
1:1,000 @ A3

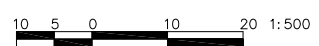

Original sheet size A1

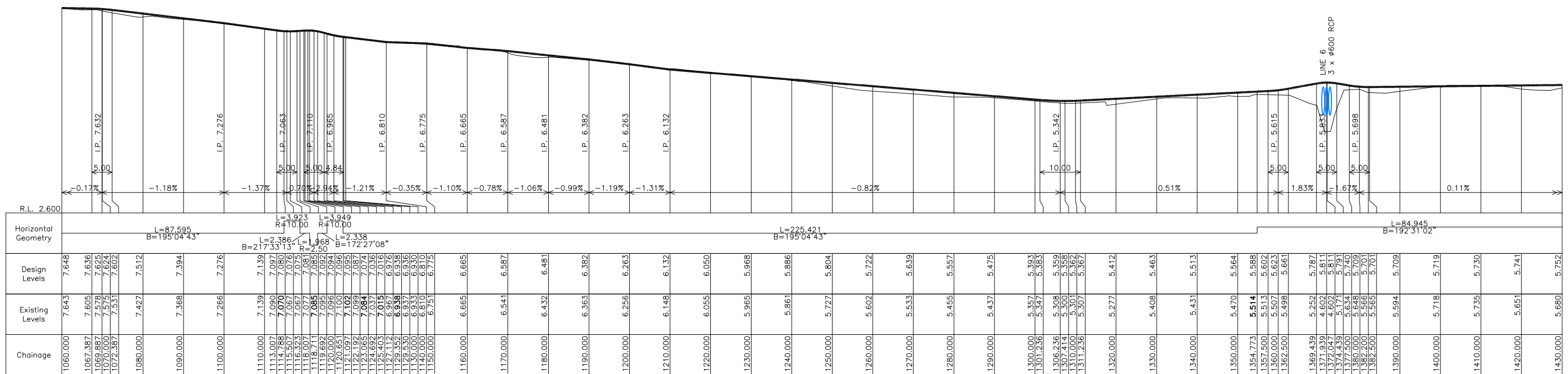

**EASTERN EDGE OF PATH LONGITUDINAL SECTION – VIEW 4**

SCALES H 1:500 @ A1, 1:1,000 @ A3  
V 1:50 @ A1, 1:100 @ A3

ISSUE	DESCRIPTION	DATE
B	RE-ISSUED FOR CONSTRUCTION	18/10/21
A	ISSUED FOR CONSTRUCTION	24/09/21

**ISSUED FOR CONSTRUCTION**

FOOTPRINT (NSW) PTY. LTD. AUTHORISE THE USE OF THIS DRAWING ONLY FOR THE PURPOSE DEMONSTRATED BY THE STATUS STAMP SHOWN ABOVE.

SCALES: AS NOTED ORIGINAL: A1

CLIENT: Shoalhaven City Council

SURVEYOR:	SCC
DATUM:	AHD
AZIMUTH:	MGA
DRAWN:	AB
DESIGNED:	AB
DESIGNED DATE:	AUG 2021
CHECKED:	AB

**footprint**  
sustainable engineering  
a. 15 meehan drive  
kiama downs nsw 2533  
p. 02 4237 6770  
m. 0430 421 661

**MURRAMARANG ROAD, BAWLEY POINT**

PROPOSED SHARED USER PATH  
BAWLEY POINT TO KIOLOA  
PLAN AND LONGITUDNAL SECTION - VIEW 4

Shoalhaven City Council  
PLAN REFERENCE: 5515.06

DRAWING NO. 2062-C06  
ISSUE: B  
SHEET 6 OF 26